

ENCROACHMENT PERMIT

TR-0120 (REV 6/2012)

Permit No. 0320-AOP1339	
Dist/Co/Rte/PM 03-BUT-70 PM 41 to BUT-70 PM 44.1	
Date October 15, 2020	
Fee Paid \$ EXEMPT	Deposit \$ N/A
Performance Bond Amount (1) \$ N/A	Payment Bond Amount (2) \$ N/A
Bond Company	
Bond Number (1)	Bond Number (2)

In compliance with (Check one):

- Your application of October 14, 2020
- Utility Notice No. _____ of _____
- Agreement No. _____ of _____
- R/W Contract No. _____ of _____

TO:

Pacific Gas and Electric Company

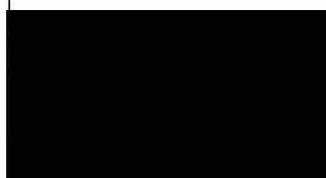

PM #35170663
Caltrans EA 031J110

, PERMITTEE

and subject to the following, PERMISSION IS HEREBY GRANTED to:
Construct underground electric distribution power line along State Route 70 near Concow, Berry Creek and Pulga.

The Caltrans representative's contact information is:

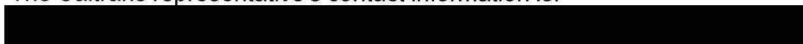

THIS PERMIT IS NOT A PROPERTY RIGHT AND DOES NOT TRANSFER WITH THE PROPERTY TO A NEW OWNER.

The following attachments are also included as part of this permit (Check applicable):

- Yes No General Provisions
- Yes No Utility Maintenance Provisions
- Yes No Special Provisions T-9, T-10, T-13
- Yes No A Cal-OSHA permit, if required: Permit No. _____
- Yes No As-Built Plans Submittal Route Slip for Locally Advertised Projects
- Yes No Storm Water Pollution Protection Plan

In addition to fee, the permittee will be billed actual costs for:

- Yes No Review
- Yes No Inspection
- Yes No Field work

(If any Caltrans effort expended)

Yes No The information in the environmental documentation has been reviewed and considered prior to approval of this permit.

This permit is void unless the work is completed before November 1, 2021

This permit is to be strictly construed and no other work other than specifically mentioned is hereby authorized.
No project work shall be commenced until all other necessary permits and environmental clearances have been obtained

Permit Inspector cc: Nevada City Maint. Station Project Manager	
---------------------------------------------------------------------------	--

ADA Notice For individuals with sensory disabilities, this document is available in alternate formats. For information call (916) 654-6410 or TDD (916) 654-3880 or write Records and Forms Management, 1120 N Street, MS-89, Sacramento, CA 95814.

1. **AUTHORITY:** The California Department of Transportation ("Department") has authority to issue encroachment permits under Division 1, Chapter 3, Article 1, Sections 660 through 734 of the Streets and Highways Code.
 2. **REVOCAION:** Encroachment permits are revocable on five (5) business days' notice unless otherwise stated on the permit and except as provided by law for public corporations, franchise holders, and utilities. Notwithstanding the foregoing, in an emergency situation as determined by the Department, an encroachment permit may be revoked immediately. These General Provisions and any applicable Special Provisions are subject to modification or abrogation by the Department at any time. Permittees' joint use agreements, franchise rights, reserved rights or any other agreements for operating purposes in State of California ("State") highway right-of-way may be exceptions to this revocation.
 3. **DENIAL FOR NONPAYMENT OF FEES:** Failure to pay encroachment permit fees when due may result in rejection of future applications and denial of encroachment permits.
 4. **ASSIGNMENT:** This encroachment permit allows only the Permittee or Permittee's authorized agent to work within or encroach upon the State Highway System, and the Permittee may not assign this permit.
 5. **ACCEPTANCE OF PROVISIONS:** Permittee understands and agrees to accept and comply with these General Provisions, the Special Provisions, any and all terms and/or conditions contained in or incorporated into the encroachment permit, and all attachments to the encroachment permit (collectively "the Permit Conditions"), for any encroachment, work, and/or activity to be performed under this encroachment permit and/or under color of authority of this encroachment permit. Permittee understands and agrees the Permit Conditions are applicable to and enforceable against Permittee as long as the encroachment remains in, under, or over any part of the State Highway System.
 6. **BEGINNING OF WORK:** When traffic is not impacted (see General Provision Number 35), the Permittee must notify the Department's representative two (2) business days before starting permitted work. Permittee must notify the Department's representative if the work is to be interrupted for a period of five (5) business days or more, unless otherwise agreed upon. All work must be performed on weekdays during regular work hours, excluding holidays, unless otherwise specified in this encroachment permit.
 7. **STANDARDS OF CONSTRUCTION:** All work performed within State highway right-of-way must conform to all applicable Departmental construction standards including but not limited to: Standard Specifications, Standard Plans, Project Development Procedures Manual, Highway Design Manual and Special Provisions.
- Other than as expressly provided by these General Provisions, the Special Provisions, the Standard Specifications, Standard Plans, and other applicable Departmental standards, nothing in these General Provisions is intended to give any third party any legal or equitable right, remedy, or claim with respect to these General Provisions or any provision herein. These General Provisions are for the sole and exclusive benefit of the Permittee and the Department.
- Where reference is made in such standards to "Contractor" and "Engineer," these are amended to be read as "Permittee" and "Department's representative," respectively, for purposes of this encroachment permit.
8. **PLAN CHANGES:** Deviations from plans, specifications, and/or the Permit Conditions as defined in General Provision Number 5 are not allowed without prior approval from the Department's representative.
 9. **INSPECTION AND APPROVAL:** All work is subject to monitoring and inspection. Upon completion of work, Permittee must request a final inspection for acceptance and approval by the Department. The local public agency Permittee must not give final construction approval to its contractor until final acceptance and approval by the Department is obtained.
 10. **PERMIT AT WORKSITE:** Permittee must keep the permit package or a copy thereof at the work site at all times and must show it upon request to any Department representative or law enforcement officer. If the permit package, or a copy thereof, is not kept and made available at the work site at all times, the work must be suspended.
 11. **CONFLICTING ENCROACHMENTS:** Permittee must yield start of work to ongoing, prior authorized work adjacent to or within the limits of the Permittee's project site. When existing encroachments conflict with Permittee's work, the Permittee must bear all cost for rearrangements (e.g., relocation, alteration, removal, etc.).
 12. **PERMITS FROM OTHER AGENCIES:** This encroachment permit is invalidated if the Permittee has not obtained all permits necessary and required by law, including but not limited to permits from the California Public Utilities Commission (CPUC), California Occupational Safety and Health Administration (Cal-OSHA), or any other public agency having jurisdiction. Permittee warrants all such permits have been obtained before beginning work under this encroachment permit.
 13. **PEDESTRIAN AND BICYCLIST SAFETY:** A safe minimum continuous passageway of four (4) feet must be maintained through the work area at existing pedestrian or bicycle facilities. At no time must pedestrians be diverted onto a portion of the street used for vehicular traffic. At locations where safe alternate passageways cannot be provided, appropriate signs and barricades must be installed at the limits of construction and in advance of the limits of construction at the nearest

- crosswalk or intersection to detour pedestrians to facilities across the street. Attention is directed to Section 7-1.04, Public Safety, of the Department's Standard Specifications.
14. **PUBLIC TRAFFIC CONTROL:** As required by law, the Permittee must provide traffic control protection, warning signs, lights, safety devices, etc., and take all other measures necessary for the traveling public's safety. While providing traffic control, the needs of all road users, including but not limited to motorists, bicyclists and pedestrians, including persons with disabilities in accordance with the Americans with Disabilities Act, must be an essential part of the work activity. Lane and/or shoulder closures must comply with the Department's Standard Specifications and Standard Plans for traffic control systems, and with the applicable Special Provisions. Where issues are not addressed in the Standard Specifications, Standard Plans, and/or Special Provisions, the California Manual on Uniform Traffic Control Devices (Part 6, Temporary Traffic Control) must be followed.
 15. **MINIMUM INTERFERENCE WITH TRAFFIC:** Permittee must plan and conduct work so as to create the least possible inconvenience to the traveling public, such that traffic is not unreasonably delayed.
 16. **STORAGE OF EQUIPMENT AND MATERIALS:** The storage of equipment or materials is not allowed within State highway right-of-way, unless specified within the Special Provisions of this encroachment permit. If encroachment permit Special Provisions allow for the storage of equipment or materials within the State highway right-of-way, the equipment and material storage must also comply with Section 7-1.04, Public Safety, of the Department's Standard Specifications.
 17. **CARE OF DRAINAGE:** Permittee must provide alternate drainage for any work interfering with an existing drainage facility in compliance with the Department's Standard Specifications, Standard Plans, and/or as directed by the Department's representative.
 18. **RESTORATION AND REPAIRS IN STATE HIGHWAY RIGHT-OF-WAY:** Permittee is responsible for restoration and repair of State highway right-of-way resulting from permitted work (Streets and Highways Code, section 670 et seq.).
 19. **STATE HIGHWAY RIGHT-OF-WAY CLEAN UP:** Upon completion of work, Permittee must remove and dispose of all scraps, refuse, brush, timber, materials, etc. off the State highway right-of-way. The aesthetics of the highway must be as it was before work started or better.
 20. **COST OF WORK:** Unless stated otherwise in the encroachment permit or a separate written agreement with the Department, the Permittee must bear all costs incurred for work within the State highway right-of-way and waives all claims for indemnification or contribution from the State, the Department, and from the Directors, officers, and employees of the State and/or the Department.
 21. **ACTUAL COST BILLING:** When specified in the permit, the Department will bill the Permittee actual costs at the currently set Standard Hourly Rate for encroachment permits.
 22. **AS-BUILT PLANS:** When required, Permittee must submit one (1) set of folded as-built plans within thirty (30) calendar days after completion and acceptance of work in compliance with requirements listed as follows:
 - a) Upon completion of the work provided herein, the Permittee must submit a paper set of As-Built plans to the Department's representative.
 - b) All changes in the work will be shown on the plans, as issued with the permit, including changes approved by Encroachment Permit Rider.
 - c) The plans are to be prominently stamped or otherwise noted "AS-BUILT" by the Permittee's representative who was responsible for overseeing the work. Any original plan that was approved with a Department stamp, or by signature of the Department's representative, must be used for producing the As-Built plans.
 - d) If construction plans include signing or striping, the dates of signing or striping removal, relocation, or installation must be shown on the As-Built plans when required as a condition of the encroachment permit. When the construction plans show signing and striping for staged construction on separate sheets, the sheet for each stage must show the removal, relocation, and installation dates of the appropriate staged striping and signing.
 - e) As-Built plans must contain the Encroachment Permit Number, County, Route, and Post Mile on each sheet.
 - f) The As-Built Plans must not include a disclaimer statement of any kind that differs from the obligations and protections provided by sections 6735 through 6735.6 of the California Business and Professions Code. Such statements constitute non-compliance with Encroachment Permit requirements and may result in the Department retaining Performance Bonds or deposits until proper plans are submitted. Failure to comply may also result in denial of future encroachment permits or a provision requiring a public agency to supply additional bonding.
 23. **PERMITS FOR RECORD PURPOSES ONLY:** When work in the State highway right-of-way is within an area under a Joint Use Agreement (JUA) or a Consent to Common Use Agreement (CCUA), a fee exempt encroachment permit is issued to the Permittee for the purpose of providing a notice and record of work. The Permittee's prior rights must be preserved without the intention of creating new or different rights or obligations. "Notice and Record Purposes Only" must be stamped across the face of the encroachment permit.
 24. **BONDING:** The Permittee must file bond(s), in advance, in the amount(s) set by the Department and using forms acceptable to the Department. The bonds must name the

Department as obligee. Failure to maintain bond(s) in full force and effect will result in the Department stopping all work under this encroachment permit and possibly revoking other encroachment permit(s). Bonds are not required of public corporations or privately-owned utilities unless Permittee failed to comply with the provisions and/or conditions of a prior encroachment permit. The surety company is responsible for any latent defects as provided in California Code of Civil Procedure section 337.15. A local public agency Permittee also must comply with the following requirements:

- a) In recognition that project construction work done on State property will not be directly funded and paid by State, for the purpose of protecting stop notice claimants and the interests of State relative to successful project completion, the local public agency Permittee agrees to require the construction contractor to furnish both a payment and performance bond in the local public agency's name with both bonds complying with the requirements set forth in Section 3-1.05 Contract Bonds of the Department's Standard Specifications before performing any project construction work.
 - b) The local public agency Permittee must defend, indemnify, and hold harmless the State and the Department, and the Directors, officers, and employees of the State and/or Department, from all project construction related claims by contractors, subcontractors, and suppliers, and from all stop notice and/or mechanic's lien claimants. The local public agency also agrees to remedy, in a timely manner and to the Department's satisfaction, any latent defects occurring as a result of the project construction work.
25. **FUTURE MOVING OF INSTALLATIONS:** Permittee understands and agrees to relocate a permitted installation upon notice by the Department. Unless under prior property right or agreement, the Permittee must comply with said notice at the Permittee's sole expense.
26. **ENVIRONMENTAL:**
- a) **ARCHAEOLOGICAL/HISTORICAL:** If any archaeological or historical resources are identified or encountered in the work vicinity, the Permittee must immediately stop work, notify the Department's representative, retain a qualified archaeologist who must evaluate the site at Permittee's expense, and make recommendations to the Department's representative regarding the continuance of work.
 - b) **HAZARDOUS MATERIALS:** If any hazardous waste or materials (such as underground storage tanks, asbestos pipes, contaminated soil, etc.) are identified or encountered in the work vicinity, the Permittee must immediately stop work, notify the Department's representative, retain a qualified hazardous waste/material specialist who must evaluate the site at Permittee's expense, and make recommendations

to the Department's representative regarding the continuance of work.

Attention is directed to potential aerially deposited lead (ADL) presence in unpaved areas along highways. It is the Permittee's responsibility to take all appropriate measures to protect workers in conformance with California Code of Regulations Title 8, Section 1532.1, "Lead," and with Cal-OSHA Construction Safety Orders, and to ensure roadway soil management is in compliance with Department of Toxic Substances Control (DTSC) requirements.

27. **PREVAILING WAGES:** Work performed by or under an encroachment permit may require Permittee's contractors and subcontractors to pay appropriate prevailing wages as set by the California Department of Industrial Relations. Inquiries or requests for interpretations relative to enforcement of prevailing wage requirements must be directed to the California Department of Industrial Relations.
28. **LIABILITY, DEFENSE, AND INDEMNITY:** The Permittee agrees to indemnify and save harmless the State, the Department, and the Directors, officers, employees, agents and/or contractors of the State and/or of the Department, including but not limited to the Director of Transportation and the Deputy Directors, from any and all claims, demands, damages, costs, liability, suits, or actions of every name, kind, and description, including but not limited to those brought for or on account of property damage, invasion of privacy, violation or deprivation of a right under a state or federal law, environmental damage or penalty, or injury to or death of any person including but not limited to members of the public, the Permittee, persons employed by the Permittee, and/or persons acting on behalf of the Permittee, arising out of or in connection with: (a) the issuance and/or use of this encroachment permit; and/or (b) the encroachment, work, and/or activity conducted pursuant to this encroachment permit, or under color of authority of this encroachment permit but not in full compliance with the Permit Conditions as defined in General Provision Number 5 ("Unauthorized Work or Activity"); and/or (c) the installation, placement, design, existence, operation, and/or maintenance of the encroachment, work, and/or activity; and/or (d) the failure by the Permittee or anyone acting on behalf of the Permittee to perform the Permittee's obligations under any part of the Permit Conditions as defined in General Provision Number 5, in respect to maintenance or any other obligation; and/or (e) any change to the Department's property or adjacent property, including but not limited to the features or conditions of either of them, made by the Permittee or anyone acting on behalf of the Permittee; and/or (f) a defect or obstruction related to or caused by the encroachment, work, and/or activity whether conducted in compliance with the Permit Conditions as defined in General Provision Number 5 or constituting Unauthorized Work or Activity, or from any cause whatsoever. The duty

of the Permittee to indemnify and save harmless includes the duties to defend as set forth in Section 2778 of the Civil Code.

It is the intent of the parties that except as prohibited by law, the Permittee will defend, indemnify, and hold harmless as set forth in this General Provision Number 28 regardless of the existence or degree of fault or negligence, whether active or passive, primary or secondary, on the part of: the State; the Department; the Directors, officers, employees, agents and/or contractors of the State and/or of the Department, including but not limited to the Director of Transportation and the Deputy Directors; the Permittee; persons employed by the Permittee; and/or persons acting on behalf of the Permittee.

The Permittee waives any and all rights to any type of expressed or implied indemnity from or against the State, the Department, and the Directors, officers, employees, agents, and/or contractors of the State and/or of the Department, including but not limited to the Director of Transportation and the Deputy Directors.

The Permittee understands and agrees to comply with the obligations of Titles II and III of the Americans with Disabilities Act in the conduct of the encroachment, work, and/or activity whether conducted pursuant to this encroachment permit or constituting Unauthorized Work or Activity, and further agrees to defend, indemnify, and save harmless the State, the Department, and the Directors, officers, employees, agents, and/or contractors of the State and/or of the Department, including but not limited to the Director of Transportation and the Deputy Directors, from any and all claims, demands, damages, costs, penalties, liability, suits, or actions of every name, kind, and description arising out of or by virtue of the Americans with Disabilities Act.

The Permittee understands and agrees the Directors, officers, employees, agents, and/or contractors of the State and/or of the Department, including but not limited to the Director of Transportation and the Deputy Directors, are not personally responsible for any liability arising from or by virtue of this encroachment permit.

For the purpose of this General Provision Number 28 and all paragraphs herein, "contractors of the State and/or of the Department" includes contractors and their subcontractors under contract to the State and/or the Department.

This General Provision Number 28 and all paragraphs herein take effect immediately upon issuance of this encroachment permit, and apply before, during, and after the encroachment, work, and/or activity contemplated under this encroachment permit, whether such work is in compliance with the Permit Conditions as defined in General Provision Number 5 or constitutes Unauthorized Work or Activity, except as otherwise provided by California law. The Permittee's obligations to defend, indemnify, and save harmless under this General Provision Number 28 take effect immediately upon

issuance of this encroachment permit and have no expiration date, including but not limited to situations in which this encroachment permit expires or is revoked, the work or activity performed under this encroachment permit is accepted or not accepted by the Department, the encroachment, work, and/or activity is conducted in compliance with the Permit Conditions as defined in General Provision Number 5 or constitutes Unauthorized Work or Activity, and/or no work or activity is undertaken by the Permittee or by others on the Permittee's behalf.

29. **NO PRECEDENT ESTABLISHED:** This encroachment permit is issued with the understanding that it does not establish a precedent.

30. **FEDERAL CIVIL RIGHTS REQUIREMENTS FOR PUBLIC ACCOMMODATION:**

a) As part of the consideration for being issued this encroachment permit, the Permittee, on behalf of Permittee and on behalf of Permittee's personal representatives, successors in interest, and assigns, does hereby covenant and agree that:

i) No person on the grounds of race, color, or national origin may be excluded from participation in, be denied the benefits of, or be otherwise subjected to discrimination in the use of said facilities.

ii) That in connection with the construction of any improvements on said lands and the furnishings of services thereon, no discrimination must be practiced in the selection and retention of first-tier subcontractors in the selection of second-tier subcontractors.

iii) That such discrimination must not be practiced against the public in their access to and use of the facilities and services provided for public accommodations (such as eating, sleeping, rest, recreation), and operation on, over, or under the space of the State highway right-of-way.

iv) That the Permittee must use the premises in compliance with all other requirements imposed pursuant to Title 15, Code of Federal Regulations, Commerce and Foreign Trade, Subtitle A. Office of the Secretary of Commerce, Part 8 (15 C.F.R. Part 8) and as said Regulations may be amended.

b) That in the event of breach of any of the above nondiscrimination covenants, the State and the Department have the right to terminate this encroachment permit and to re-enter and repossess said land and the facilities thereon and hold the same as if said permit had never been made or issued.

31. **MAINTENANCE OF HIGHWAYS:** By accepting this encroachment permit, the Permittee agrees to properly maintain any encroachment. This assurance requires the Permittee to provide inspection and repair any damage, at Permittee's expense, to State facilities resulting from the encroachment.

32. **SPECIAL EVENTS:** In accordance with subdivision (a) of Streets and Highways Code section 682.5 and 682.7, the Department is not responsible for the conduct or operation of the permitted activity, and the applicant agrees to defend, indemnify, and hold harmless the State, the Department, and the Directors, officers, employees, agents, and contractors of the State and/or of the Department, including but not limited to the Director of Transportation and the Deputy Directors, from any and all claims, demands, damages, costs, liability, suits, or actions of every name, kind and description arising out of any activity for which this encroachment permit is issued. The Permittee is required, as a condition of this encroachment permit, for any event that awards prize compensation to competitors in gendered categories, for any participant level that receives prize compensation, to ensure the prize compensation for each gendered category is identical at each participant level. (Streets and Highways Code, section 682.7.)
The Permittee understands and agrees to comply with the obligations of Titles II and III of the Americans with Disabilities Act in the conduct of the event, and further agrees to defend, indemnify, and save harmless the State and the Department, and the Directors, officers, and employees of the State and/or Department, including but not limited to the Director of the Department and the Deputy Directors, from any and all claims, demands, damages, costs, liability, suits, or actions of every name, kind and description arising out of or by virtue of the Americans with Disabilities Act.
33. **PRIVATE USE OF STATE HIGHWAY RIGHT-OF-WAY:** State highway right-of-way must not be used for private purposes without compensation to the State. The gifting of public property uses and therefore public funds is prohibited under the California Constitution, Article XVI, Section 6.
34. **FIELD WORK REIMBURSEMENT:** Permittee must reimburse the Department for field work performed on Permittee's behalf to correct or remedy hazards or damaged facilities, or to clear refuse, debris, etc. not attended to by the Permittee.
35. **LANE CLOSURE REQUEST SUBMITTALS AND NOTIFICATION OF CLOSURES TO THE DEPARTMENT:** Attention is directed to Section 12-4.02A(3) Submittals, of the Department's Standard Specifications, for lane closure requests submittals requirements and schedules. The Permittee must notify the Department's representative and the Traffic Management Center (TMC) before initiating a lane closure or conducting an activity that may cause a traffic impact. In emergency situations when the corrective work or the emergency itself may affect traffic, the Department's representative and the TMC must be notified as soon as possible.
36. **SUSPENSION OF TRAFFIC CONTROL OPERATION:** The Permittee, upon notification by the Department's representative, must immediately suspend all lane closure operations and any operation that impedes the flow of traffic. All costs associated with this suspension must be borne by the Permittee.
37. **UNDERGROUND SERVICE ALERT (USA) NOTIFICATION:** Any excavation requires compliance with the provisions of Government Code section 4216 et. seq., including but not limited to notice to a regional notification center, such as Underground Service Alert (USA). The Permittee must provide notification to the regional notification center at least forty-eight (48) hours before performing any excavation work within the State highway right-of-way.
38. **COMPLIANCE WITH THE AMERICANS WITH DISABILITIES ACT (ADA):** All work within the State highway right-of-way to construct and/or maintain any public facility must be designed, maintained, and constructed strictly in accordance with all applicable Federal Access laws and regulations (including but not limited to Section 504 of the Rehabilitation Act of 1973, codified at 29 U.S.C. § 794), California Access laws and regulations relating to ADA, along with its implementing regulations, Title 28 of the Code of Federal Regulations Parts 35 and 36 (28 C.F.R., Ch. I, Part 35, § 35.101 et seq., and Part 36, § 36.101 et seq.), Title 36 of the Code of Federal Regulations Part 1191 (36 C.F.R., Ch. XI, Part 1191, § 1191.1 et seq.), Title 49 of the Code of Federal Regulations Part 37 (49 C.F.R., Ch. A, Part 37, § 37.1 et seq.), the United States Department of Justice Title II and Title III for the ADA, and California Government Code section 4450 et seq., which require public facilities be made accessible to persons with disabilities.
Notwithstanding the requirements of the previous paragraph, all construction, design, and maintenance of public facilities must also comply with the Department's Design Information Bulletin 82, "Pedestrian Accessibility Guidelines for Highway Projects."
39. **STORMWATER:** The Permittee is responsible for full compliance with the following:
- For all projects, the Department's Storm Water Program and the Department's National Pollutant Discharge Elimination System (NPDES) Permit requirements under Order No. 2012-0011-DWQ, NPDES No CAS000003; and
 - In addition, for projects disturbing one acre or more of soil, with the California Construction General Permit Order No. 2009-0009-DWQ, NPDES No CAS000002; and
 - In addition, for projects disturbing one acre or more of soil in the Lahontan Region with Order No. R6T-2016-0010, NPDES No CAG616002.
 - For all projects, it is the Permittee's responsibility to install, inspect, repair, and maintain all facilities and devices used for water pollution control practices (Best Management Practices/BMPs) before performing daily work activities.

DIST.	COUNTY	ROUTE	POST MILE TOTAL PROJECT	SPRINT MILE TOTAL	TOTAL SHEETS

NO PART OF THE DESIGN OR THE MATERIALS OR METHODS SHALL BE RESPONSIBLE FOR THE SAFETY OR COMPLETION OF ANY WORK UNDER THE TERMS OF THIS PLAN SHEET.

DATE OF THE PRINT

TABLE 1

SPEED (S)	MINIMUM TAPER LENGTH * FOR WIDTH OF OFFSET 12 FEET (W)				MAXIMUM CHANNELIZING DEVICE SPACING		
	TANGENT 2L	MERGING L	SHIFTING L/2	SHOULDER L/3	X	Y	Z **
					TAPER	TANGENT	CONFLICT
mph	ft	ft	ft	ft	ft	ft	ft
20	160	80	40	27	20	40	10
25	250	125	63	42	25	50	12
30	360	180	90	60	30	60	15
35	490	245	123	82	35	70	17
40	640	320	160	107	40	80	20
45	1080	540	270	180	45	90	22
50	1200	600	300	200	50	100	25
55	1320	660	330	220	50	100	25
60	1440	720	360	240	50	100	25
65	1560	780	390	260	50	100	25
70	1680	840	420	280	50	100	25
75	1800	900	450	300	50	100	25

* - For other offsets, use the following merging taper length formula for L:
 For speed of 40 mph or less, $L = WS^2/60$
 For speed of 45 mph or more, $L = WS$

Where: L = Taper length in feet

W = Width of offset in feet

S = Posted speed limit, off-peak 85th-percentile speed prior to work starting, or the anticipated operating speed in mph

** - Use for taper and tangent sections where there are no pavement markings or where there is a conflict between existing pavement markings and channelizers (CA).

TABLE 2

SPEED *	Min D **	DOWNGRADE Min D ***		
		-3%	-6%	-9%
		ft	ft	ft
mph	ft	ft	ft	ft
20	115	116	120	126
25	155	156	165	173
30	200	205	215	227
35	250	257	271	287
40	305	315	333	354
45	360	378	400	427
50	425	446	474	507
55	495	520	553	593
60	570	598	638	686
65	645	682	728	785
70	730	771	825	891
75	820	866	927	1003

* - Speed is posted speed limit, off-peak 85th-percentile speed prior to work starting, or the anticipated operating speed in mph

** - Longitudinal buffer space or flagger station spacing

*** - Use on sustained downgrade steeper than -3 percent and longer than 1 mile.

TABLE 3

ROAD TYPE	DISTANCE BETWEEN SIGNS *		
	A	B	C
	ft	ft	ft
URBAN - 25 mph OR LESS	100	100	100
URBAN - MORE THAN 25 mph TO 40 mph	250	250	250
URBAN - MORE THAN 40 mph	350	350	350
RURAL	500	500	500
EXPRESSWAY / FREEWAY	1000	1500	2640

* - The distances are approximate, are intended for guidance purposes only, and should be applied with engineering judgment. These distances should be adjusted by the Engineer for field conditions, if necessary, by increasing or decreasing the recommended distances.

2018 STANDARD PLAN T9

STATE OF CALIFORNIA
 DEPARTMENT OF TRANSPORTATION
**TRAFFIC CONTROL SYSTEM TABLES
 FOR LANE AND RAMP CLOSURES**
 NO SCALE

T9

Return to Table of Contents

286

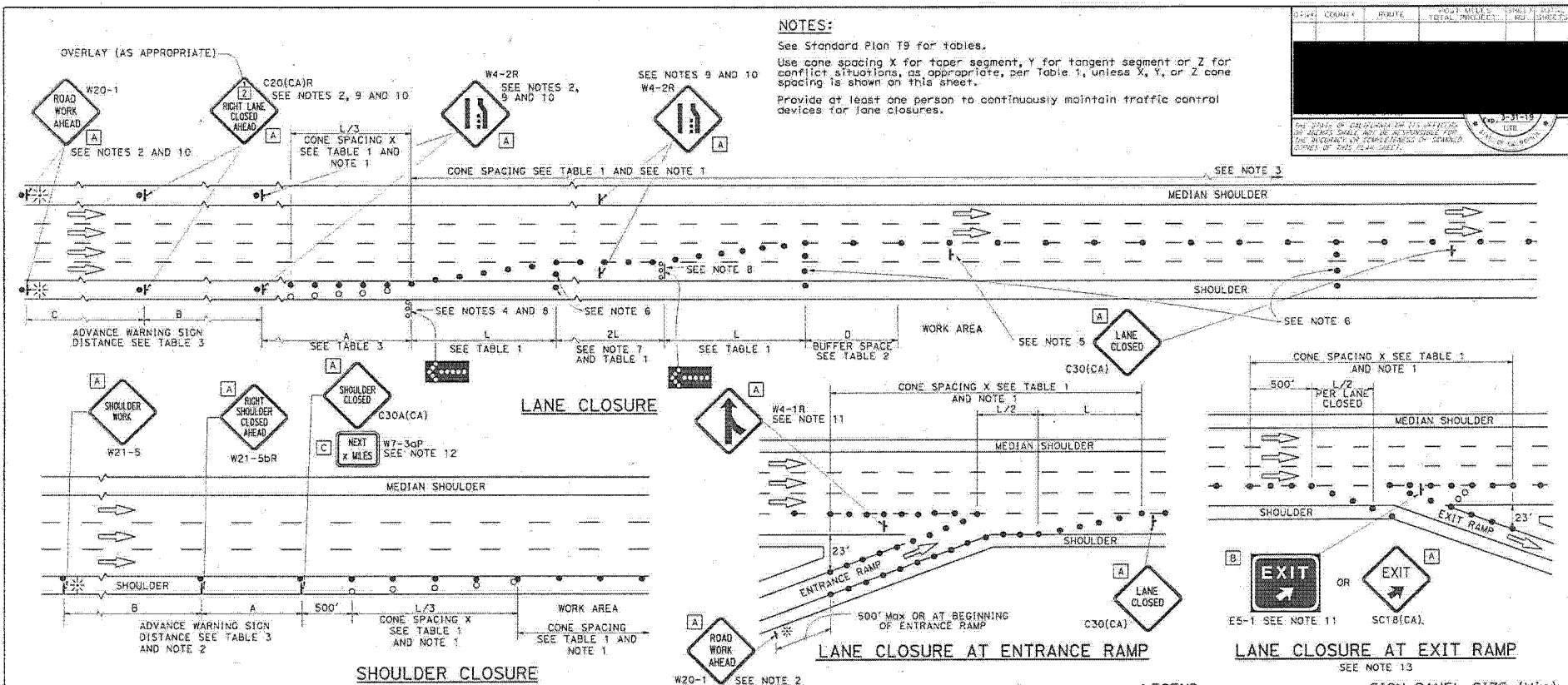

NOTES:
 See Standard Plan T9 for tables.
 Use cone spacing X for taper segment, Y for tangent segment or Z for conflict situations, as appropriate, per Table 1, unless X, Y, or Z cone spacing is shown on this sheet.
 Provide at least one person to continuously maintain traffic control devices for lane closures.

DATE	DESIGNED	REVISED	PROJECT MILEAGE	SHEET NO.
			TOTAL PROJECT	OF TOTAL SHEETS

THE STATE OF CALIFORNIA DEPARTMENT OF TRANSPORTATION
 THE DESIGN OF THIS PLAN SHEET IS THE RESPONSIBILITY OF THE DESIGNER. THE STATE OF CALIFORNIA DEPARTMENT OF TRANSPORTATION SHALL NOT BE RESPONSIBLE FOR THE SECURITY OR COMPLETION OF ANY WORK UNDER THIS PLAN SHEET.

Exp. 3-31-18
 10/18

- NOTES:**
1. Portable delineators placed at one-half the spacing indicated for traffic cones may be used instead of cones for daytime closures only.
 2. Each advance warning sign shall be equipped with at least two flags for daytime closure. Each flag shall be at least 16" x 16" in size and shall be orange or fluorescent red-orange in color. Flashing beacons shall be placed at the locations indicated for lane closure during hours of darkness.
 3. A W20-2 "END ROAD WORK" sign, with minimum size of 48" x 24" as appropriate, shall be placed at the end of the lane closure unless the end of work area is obvious or ends within the larger project's limits.
 4. A minimum 1500' sight distance shall be provided where possible for vehicles approaching the first flashing arrow sign. Lane closures shall not begin at the top of crest vertical curve or on a horizontal curve.

5. Place a C30(CA) sign every 1000' throughout length of lane closure.
6. A minimum of 3 cones shall be placed transversely across each closed lane and shoulder at each location where a taper across a traffic lane ends, and every 1000' as shown on the "Lane Closure" detail. Two type I barricades may be used instead of the 3 cones. The transverse alignment of the cones or barricades on the closed shoulder may be shifted from the transverse alignment to provide access to the work.
7. The 2L tangent shown along lane lines shall be used between the L tapers required for each closed traffic lane.
8. Use one flashing arrow sign for each lane closed. The flashing arrow sign shall be Type I.
9. Median lane closures shall conform to the details as shown except that C20(CA)L and W4-2L signs shall be used.

10. Duplicate sign installations are not required:
 - a) On opposite shoulder if at least one-half of the available lanes remain open to traffic.
 - b) In the median if the width of the median shoulder is less than 8' and the outside lanes are to be closed.
11. The ES-1 or SC18(CA) and W4-1 signs shall be used as shown.
12. A W7-30P "NEXT _____ MILES" plaque must be used if the shoulder closure extends beyond the distance that can be perceived by road users.
13. For the warning sign requirements at the Exit Ramp, when work is proposed on the local street, see CA MUTCD Figure 6H-22 to 6H-27.

LEGEND

- TRAFFIC CONE
- TRAFFIC CONE (OPTIONAL TAPER)
- † TEMPORARY TRAFFIC CONTROL SIGN
- ⚡ FLASHING ARROW SIGN (FAS)
- ☁ FAS SUPPORT OR TRAILER
- ☼ PORTABLE FLASHING BEACON

SIGN PANEL SIZE (Min)

A	48" x 48"
B	72" x 60"
C	36" x 30"

STATE OF CALIFORNIA
 DEPARTMENT OF TRANSPORTATION

TRAFFIC CONTROL SYSTEM FOR LANE CLOSURE ON FREEWAYS AND EXPRESSWAYS

NO SCALE

T10

2018 STANDARD PLAN T10

Return to Table of Contents

NOTES:

See Standard Plan T9 for tables.

Use cone spacing X for taper segment, Y for tangent segment or Z for conflict situations, as appropriate, per Table 1, unless X, Y, or Z cone spacing is shown on this sheet.

Provide at least one person to continuously maintain traffic control devices for lane closures.

DIST.	COUNTY	ROUTE	POST MILES TOTAL PROJECT	SHEET NO.	TOTAL SHEETS

PLANS APPROVAL DATE: 3-31-19

THE STATE OF CALIFORNIA OR ITS OFFICERS OR AGENTS SHALL NOT BE RESPONSIBLE FOR THE ACCURACY OR COMPLETENESS OF SCHEMATIC CONTENTS OF THIS PLAN SHEET.

TYPICAL LANE CLOSURE WITH REVERSIBLE CONTROL

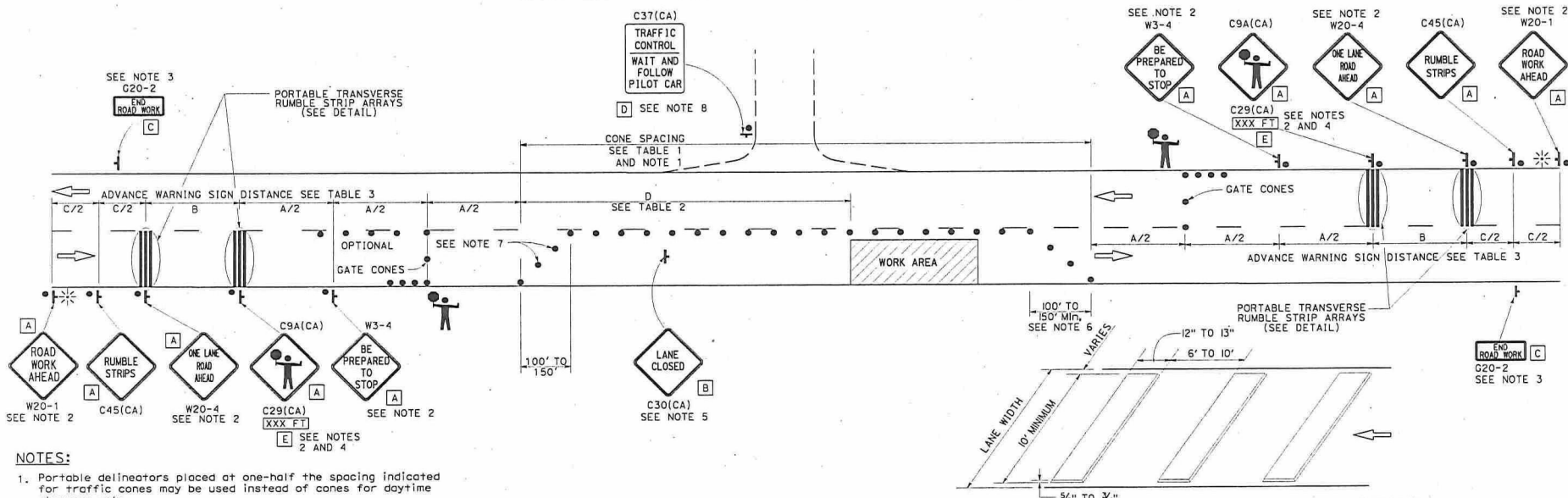

NOTES:

- Portable delineators placed at one-half the spacing indicated for traffic cones may be used instead of cones for daytime closures only.
- Each advance warning sign shall be equipped with at least two flags for daytime closure. Each flag shall be at least 16" x 16" in size and shall be orange or fluorescent red-orange in color. Flashing beacons shall be placed at the locations indicated for lane closure during hours of darkness.
- A G20-2 "END ROAD WORK" sign, shall be placed at the end of the lane closure unless the end of work area is obvious or ends within the larger project's limits.
- An optional C29(CA) sign may be placed below the C9A(CA) sign.
- Place C30(CA) "LANE CLOSED" sign at 500' to 1000' intervals throughout extended work area. They are optional if the work area is visible from the flagger station.
- Length may be reduced by the Engineer to address site conditions.
- Either traffic cones or barricades shall be placed on the taper. Barricades shall be Type I, II, or III.
- When a pilot car is used, place a C37(CA) "TRAFFIC CONTROL-WAIT AND FOLLOW PILOT CAR" sign with black legend on a white background at all intersections, driveways and alleys without a flagger within the traffic control area.

PORTABLE TRANSVERSE RUMBLE STRIP ARRAY DETAIL

LANE WIDTH 10' MINIMUM VARIES

100' TO 150' Min. SEE NOTE 6

12" TO 13"

6' TO 10'

5/8" TO 3/4"

LEGEND

- TRAFFIC CONE
- † TEMPORARY TRAFFIC CONTROL SIGN
- ☼ PORTABLE FLASHING BEACON
- 👤 FLAGGER

SIGN PANEL SIZE (Min)

A	48" x 48"
B	30" x 30"
C	36" x 18"
D	36" x 42"
E	20" x 7"

STATE OF CALIFORNIA
DEPARTMENT OF TRANSPORTATION

TRAFFIC CONTROL SYSTEM FOR LANE CLOSURE ON TWO LANE CONVENTIONAL HIGHWAYS

NO SCALE

T13

291

2018 STANDARD PLAN T13

Return to Table of Contents